

IMPORTANT:

If your awning is not operating it is most likely time to change the battery in your wireless remote control.

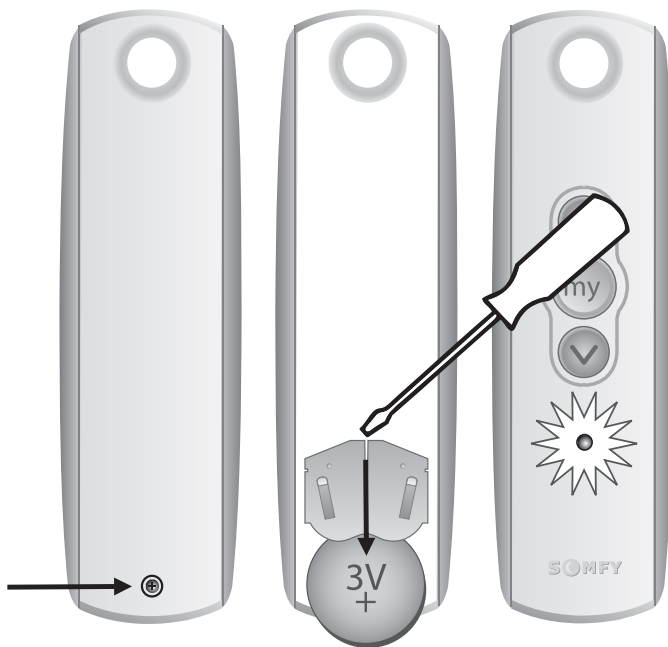

- 1) Using a small screwdriver loosen the screws on the backside of the remote control and remove the back cover.
- 2) Replace with one 2430 Lithium 3V battery.
- 3) Indicator light on remote will illuminate.

If red light is illuminated and the awning is still not operating please check that you are receiving power to the receptacle.